

SITE PLAN OF SMT. NIVADEB BARMAN, SMT. NILA MITRA, & SMT. KAJAL GHOSH AT HOLDING NO:- 1, BANGASHREE PALLY -II, IN WARD NO:- 22 UNDER CHAMPDANY MUNICIPALITY, HOOGHLY.

(SCALE:-1:250)

LAND REFN.:-

MOUZA:- GOURHATI-CHAMPDANI, J.L. NO:- 21
 R.S. DAG NO:- 287, R.S. KHATIAN NO:- 2560, 2561, 2602
 L.R. DAG NO:- 454, L.R. KHATIAN NO:- 9427, 9428, 9429, 9430
 P.S. :- BHADRESWAR, DIST:- HOOGHLY.
AREA OF LAND:- 344.16 SQ.M OR 0.085 ACRES(more or less)

CONSTRUCTION AREA:-

GROUND FLOOR AREA :- 227.41 SQM OR 2446 SFT
 FIRST FLOOR AREA :- 249.75 SQM OR 2687 SFT
 SECOND FLOOR AREA :- 249.75 SQM OR 2687 SFT
 THIRD FLOOR AREA :- 249.75 SQM OR 2687 SFT
 FOURTH FLOOR AREA :- 249.75 SQM OR 2687 SFT

PROPOSED TOTAL BUILD UP AREA :- 1226.41 SQM OR 13194 SFT

Pl. No. 325/S Dated 12/12/18
 Permission for sanction of site Plan is granted as per enclosed Plan.
 01/13/19
 Sub Assistant Engineer
 Champdany Municipality
 Vice-Chairman
 Champdany Municipality

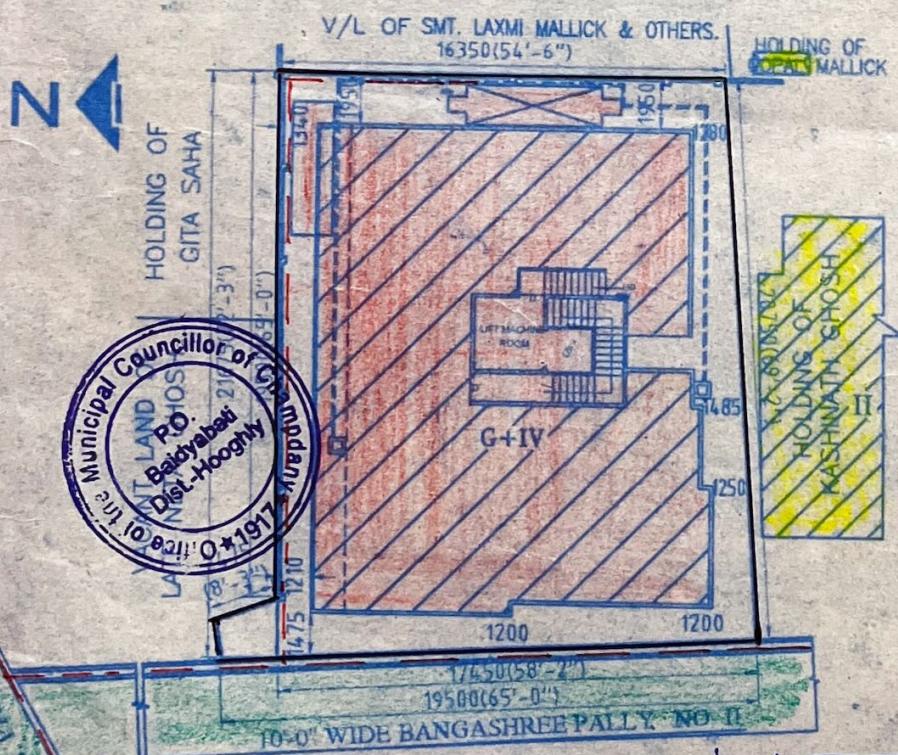

Nibha Deb Barman
 SMT. NIVA DEBBARMAN
Nila Mitra
 SMT. NILA MITRA
Kajal Ghosh
 SMT. KAJAL GHOSH
 SIGNATURE OF OWNERS

Bimal Das
 Bimal Das
 CIVIL ENGINEER (DIP)
 R. B. S. ROAD, BHADRESWAR
 B.S.No. : 12017-2018
 CHAMPDANI MUNICIPALITY
 SIGNATURE OF L.B.S.

There is no objection in this Building Plan
for
 KASHNATH GHOSH

PO. Baidyabati, Hooghly, 2/1 Bangashree Pally - 2, Ward NO - 22 under Champdany Municipality